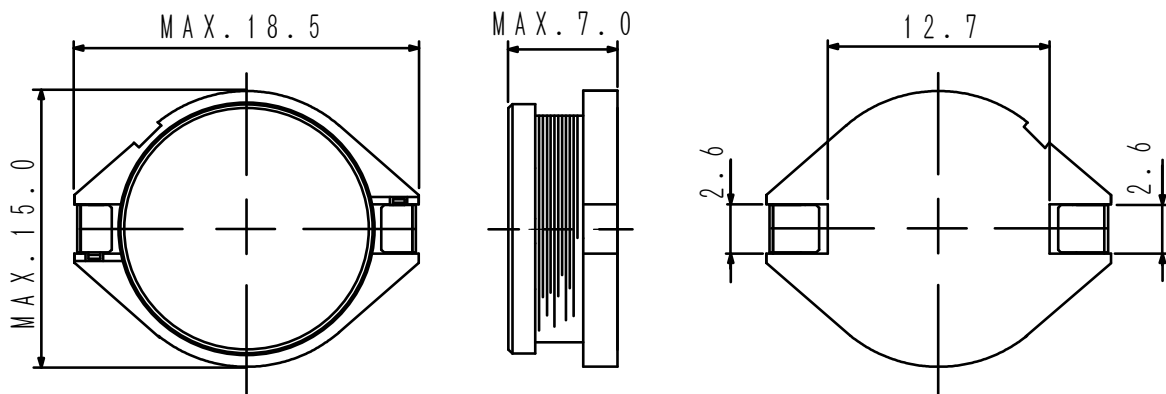
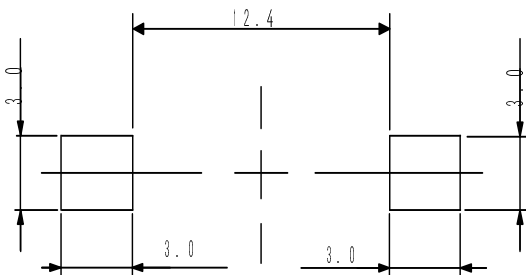

Type: CDR156
◆ Product Description

- 18.5×15.0mm Max.(L×W), 7.0mm Max. Height.
- Inductance range: 1.0 μ H~1.0mH.
- Rated current range: 0.48~10A .
- In addition to the standards versions shown here, custom inductors are also available to meet your exact requirements.

◆ Feature

- Magnetically unshielded construction.
- Storage temperature range: -40°C ~+100°C.
- Operating temperature range: -40°C ~+100°C (Including coil's self temperature rise).
- Ideally used in Notebook PC ,LCD TV ,Game machine ,HDD ,DSC/DVC , etc as DC-DC converter inductors.
- RoHS compliance.

◆ Dimensions (mm)

◆ Land Pattern (mm)

Type: CDR156
◆ Specification

Part Name ※	Stamp	Inductance (μ H) 100kHz	D.C.R.(m Ω) Max.(Typ.) (at 20°C)	Saturation Current (A) ※1	Temperature Rise Current (A) ※2
CDR156NP-1R0M□	1R0M	1.0 \pm 20%	5.3(4.2)	28.0	10.0
CDR156NP-2R5M□	2R5M	2.5 \pm 20%	8.1(6.5)	18.4	9.0
CDR156NP-3R3M□	3R3M	3.3 \pm 20%	9.8(7.8)	16.4	7.5
CDR156NP-5R6M□	5R6M	5.6 \pm 20%	13.5(10.8)	12.8	7.0
CDR156NP-6R8M□	6R8M	6.8 \pm 20%	17.5(14.0)	11.2	6.0
CDR156NP-100L□	100L	10 \pm 15%	25.0(20.0)	9.6	5.5
CDR156NP-150L□	150L	15 \pm 15%	34.5(27.6)	7.6	4.3
CDR156NP-220L□	220L	22 \pm 15%	43.5(34.8)	6.4	4.0
CDR156NP-330L□	330L	33 \pm 15%	68.0(54.4)	5.2	3.0
CDR156NP-470L□	470L	47 \pm 15%	97.8(78.2)	4.2	2.5
CDR156NP-680L□	680L	68 \pm 15%	144.6(115.7)	3.6	2.0
CDR156NP-101L□	101L	100 \pm 15%	220.0(176.0)	2.9	1.6
CDR156NP-151L□	151L	150 \pm 15%	315.2(252.2)	2.5	1.3
CDR156NP-221L□	221L	220 \pm 15%	466.3(373.0)	2.0	1.1
CDR156NP-331L□	331L	330 \pm 15%	646.0(516.8)	1.6	0.9
CDR156NP-471L□	471L	470 \pm 15%	933.3(746.6)	1.4	0.75
CDR156NP-681L□	681L	680 \pm 15%	1670(1340)	1.1	0.55
CDR156NP-102L□	102L	1000 \pm 15%	2100(1750)	0.9	0.48

※ Description of part name

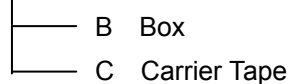
CDR156NP-1R0M□



※1.Saturation current: The DC current at which the inductance decreases to 90% of it's initial value.
(Ta=20°C)

※2. Temperature rise current: The DC current at which the temperature rise is $\Delta t=40^{\circ}\text{C}$.(Ta=20°C)